

i-dig02

Digital Communicator

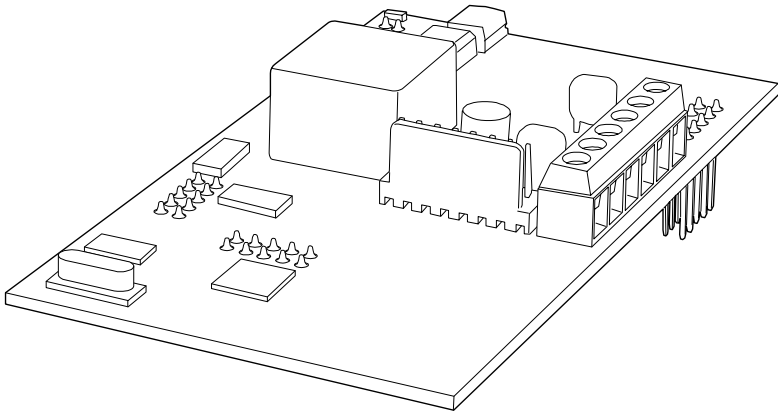

Installation Guide

Introduction

The i-dig02 module is designed to fit on the i-on40 control unit. The i-dig02 allows the control unit to report alarm conditions over the public switched telephone network (PSTN) using standard ARC protocols such as Fast Format, SIA I, -II, -III, or extended SIA, Contact ID, or SMS (Short Message Service) texts to mobile telephones by way of the PSTN. In addition the i-dig02 allows Downloader software to communicate with and monitor the control unit.

Figure 1 shows the main features of the module.

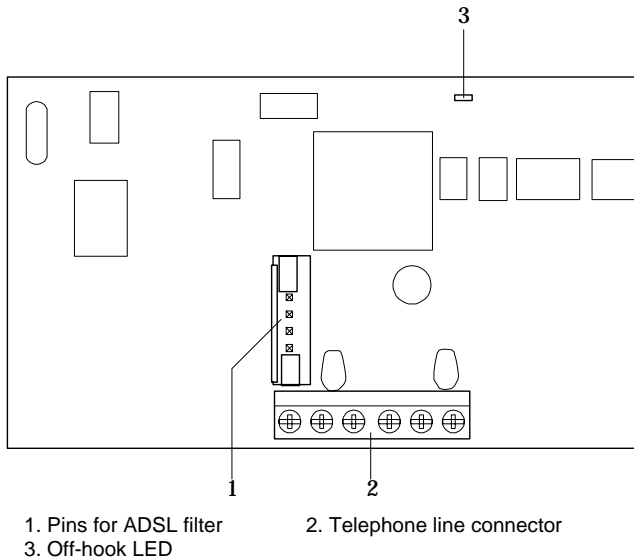

Figure 1. i-dig02 Module

Installation

Safety Notice

Figure 2 identifies connectors for Safety Extra-Low Voltage (SELV) and Telecommunications Network Voltage (TNV) circuits on the control unit's main PCB. These terms are used in accordance with the definitions in Safety Standard EN60 950.

The Installer must ensure that TNV terminals are connected **only** to other circuits designated as TNV circuits (for example, the PTSN)

i-dig02

and that SELV terminals are connected **only** to other circuits designated as SELV circuits. Strict adherence to the installation instructions will ensure that the equipment continues to comply with the safety regulations to which it was approved.

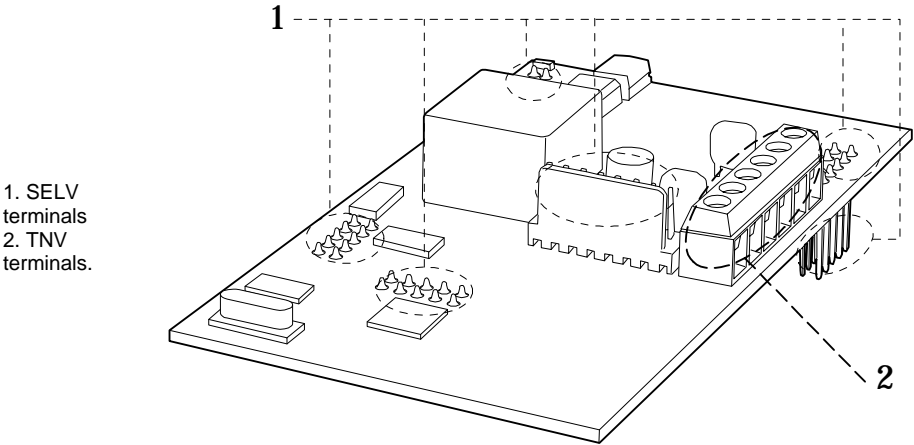

Figure 2. SELV and TNV Terminals

CAUTION: Make sure that the end station is not powered (either mains or battery) before fitting the i-dig02.

Preparation

Before fitting the i-dig02 module, check whether the telephone line you intend to use is shared with an ADSL (broadband) modem. If it is, then remove the factory fitted jumpers from the i-dig02 and fit filter ADSL01 as shown in Figure 3 .

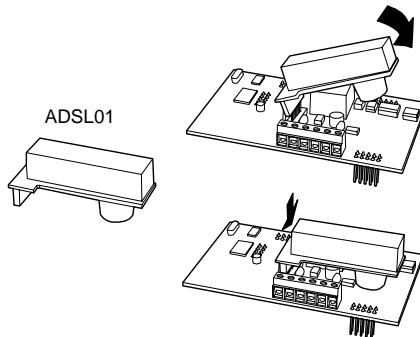

Figure 3. Fitting ADSL01 to i-dig02

Note: If the telephone line is NOT shared with an ADSL modem then leave the factory fitted jumpers in place.

Installing the Module in the End Station

1. Remove mains power from the end station.
2. Open the end station lid and disconnect the battery.
3. Fit the i-dig02 to the plug on module sockets (see Figure 4).

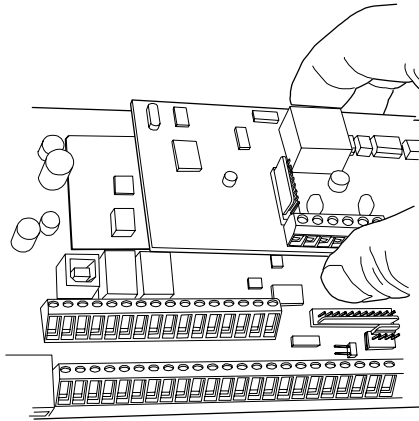
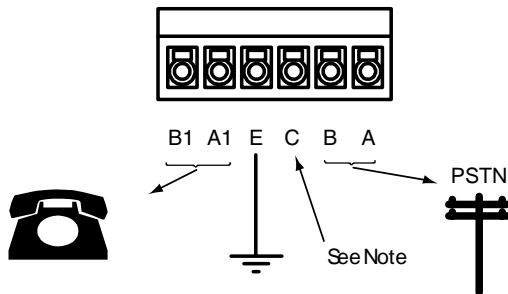

Figure 4. Fitting i-dig02 Module

4. Connect the module to the PSTN.



WARNING: Telecommunications Network Voltage

- A, B Connect to PSTN
- A1, B1 Connect to local phone extension (if required)
- E For added surge protection connect to a suitable protective earth.
- C Note: (UK only) connect to ringing wire from PSTN and to ringing wire on extension phone, if fitted.

Figure 5. Telephone Connection

i-dig02

The person connecting the i-dig02 module to the PSTN must be suitably qualified. Connect the i-dig02 telephone connector (see Figure 5) ONLY to the PSTN or to other circuits designated as Telecommunications Network Voltage.

Programming

For details on programming the i-dig02 please refer to the *i-on40 Programming Reference Guide*. All the options necessary for programming the module are in the Installer Menu under the Communications – ARC Reporting option.

Note: The control unit hides the Communications - ARC Reporting option if there is no i-dig02 fitted.

Finishing the Installation

Once programming is complete:

Re-fit the lid of the end station.

Test the module using the options in the *Installer Menu - Test* option.

NOTES:

i-dig02

NOTES:

© Cooper Security Ltd. 2009

Every effort has been made to ensure that the contents of this book are correct. However, neither the authors nor Cooper Security Limited accept any liability for loss or damage caused or alleged to be caused directly or indirectly by this book. The contents of this book are subject to change without notice.

Printed and published in the U.K.

This manual applies to software used in the I-ON40 control unit with version 1.xx.xx software.

www.coopersecurity.co.uk

Product Support (UK) Tel: +44 (0) 870 757 5400.

Available between:

08:15 and 17:00 Monday to Friday.

Product Support Fax: (01594) 545401

Part Number 11966531 Issue 1